

BLOKSET

施耐德授权产品

配电箱
Distribution Box



产品概述

Blokset 配电箱是施耐德公司授权我公司生产的新一代高可靠性的低压系统。适合于工业与民用建筑中作交流频率为 50HZ、电压 500V 及以下、三相四线电力系统的动力配电和照明配电用。同时适合制作各种电动机启动柜，包括全压直接启动柜，全数字控制软启动柜、自耦降压启动柜，星三角启动柜，多速电动机启动柜等。具有数十种一次线路方案号或派生方案号，供选择使用，适用范围广。

Product Summary

Blokset distribution box is a new generation of low voltage distribution box system with high reliability, authorized by Schneider, produced by our company. It is used for power distribution and light distribution of three-phase four-wire power system of AC frequency 50HZ, voltage 500V or lower in industrial and civil buildings. Besides, it is also suitable for making various starting cabinets of motor, including full-voltage direct starting cabinet, full digital controlled soft starting cabinet, auto-induction voltage-reduced starting cabinet, star-delta starting cabinet, multiple speed motor starting cabinet, etc. Dozens of scheme no. or derived scheme no. of primary lines are available for selection, with a wide range of applications.

环境条件

1. 海拔高度：≤ 2000m。
2. 相对湿度：≤ 90%。
3. 环境温度：-15 ~ +45 摄氏度。
4. 工作环境：室内或室外安装。
5. 无剧烈振动与冲击。
6. 无强电磁干扰。
7. 无严重扬尘，无易燃、易爆、易腐蚀气体、导电尘埃、无严重霉菌。

Environmental Conditions

1. Altitude: No more than 2000m.
2. Relative Humidity: Average humidity no more than 90%.
3. Ambient Temperature: No more than +45℃, No less than -15℃.
4. Operating Conditions: Indoor & outdoor installation.
5. No vibration impact and shock.
6. No strong electromagnetic interference.
7. No fire, explosion danger, serious dirt, chemical corrosion and violent vibration for product installed place.

产品特点

1. 和谐美观的颜色搭配。
2. 标准化设计，结构紧凑，通用性强。
3. 三维尺寸可按需求变化。
4. 别具特色的眉头设计。
5. 柜门可开启 180°。
6. 电气安装板可单独拆卸。

Product Features

1. Harmonious and beautiful colors.
2. Standardized design, compact and flexible structure.
3. 3D demission in adapting requirement variety.
4. With unique characteristic of logo design.
5. Doors can be 180° opened.
6. Electrical installation plate can be separately removable.

技术参数

序号 Sr.	名称 Content	单位 Unit	数值 Value
1	额定工作电压 Rated Operating Voltage	V	380/690
2	额定绝缘电压 Rated Insulated Voltage	V	660/1000
3	额定频率 Rated Frequency	Hz	50
4	最大工作电流 Max. operating Current	A	≤630
5	Imin 辅助回路工频耐受电压 Aux. circuit Frequency Withstand Voltage in 1min	kV	2
6	额定脉冲耐受电压 Rated Impulse Withstand Voltage	kV	8
7	防护等级 Protect Degree	IP	IP55
8	电气间隙 Electrical Clearance	mm	20
9	爬电距离 Creepage Distance	mm	≥12.5

Technical Parameters

开关柜结构尺寸示意图

Structure Dimension and Sketch

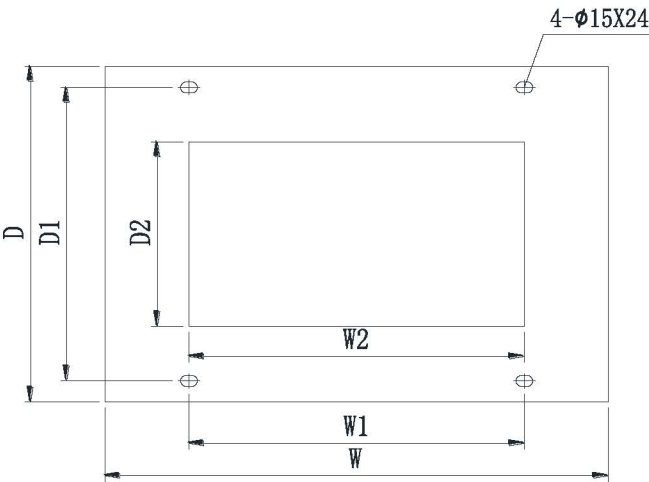

底部安装基础及电缆出线孔
Bottom Mounting Basic and Cable Outlet Hole

BLOKSET(落地箱) BLOKSET (Console)			
	外型尺寸 Overall Dimensions	安装尺寸 Installing Dimensions	电缆孔尺寸 Cable Hole Dimensions
宽度 Width	W 600-1200	W1 W-200	W2 W-200
深度 Depth	D(不含门厚) D(Without Door) 400-800	D1 D-50	D2 D-130
高度 Height	1600/1800/2000/2200		